

— PLANNING BOUNDARY LINE

AREA OF THE DEVELOPMENT TO BE TAKEN IN CHARGE BY SDCC

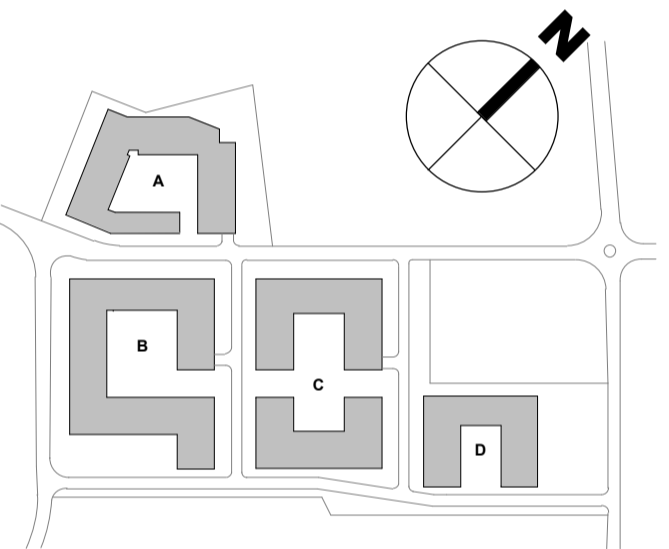

REV	DATE	SIGNED	NOTES

Project Stage

SHD Application

Client
Joseph Costello, Absolute Limousines Ltd and Boherkill Property Development Ltd.

Project
Lands west of Old Belgard Road and north, south and west of Cookstown Road, Cookstown Industrial Estate, Tallaght, Dublin 24

Drawing Title
TAKING IN CHARGE PLAN

Drawn: AB Checked: SOD Scale @ A1: As indicated Date: 12/02/19

Project No: 19127 Drawing No: 0012

Drawing BIM Name:
P19127-CWO-00-00-DR-A-0012

CDE Area	Suitability Code	Revision
	S2	



1 Sarsfield Quay, Arbour Hill, Dublin 7
t: 01 518 0170 e: admin@cwoarchitects.ie
Dublin | London | Warwick | Manchester
www.cwoarchitects.ie

Please consider the environment before printing this sheet